

CLAMPING-55mm

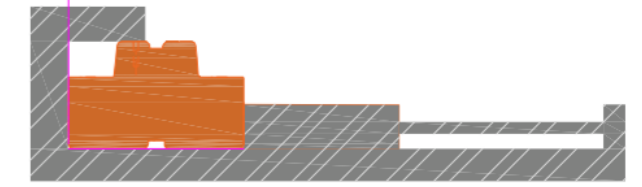

-If $25 \leq \text{height} \leq 40\text{mm}$ then workpiece minimum width is 58mm, otherwise is 50mm.
 -If orizzontal clamping is disable there will be no restriction on workpiece width.

CLAMPING-20mm

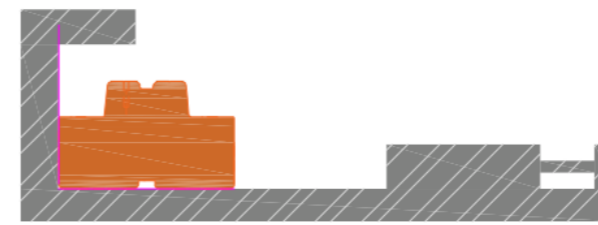
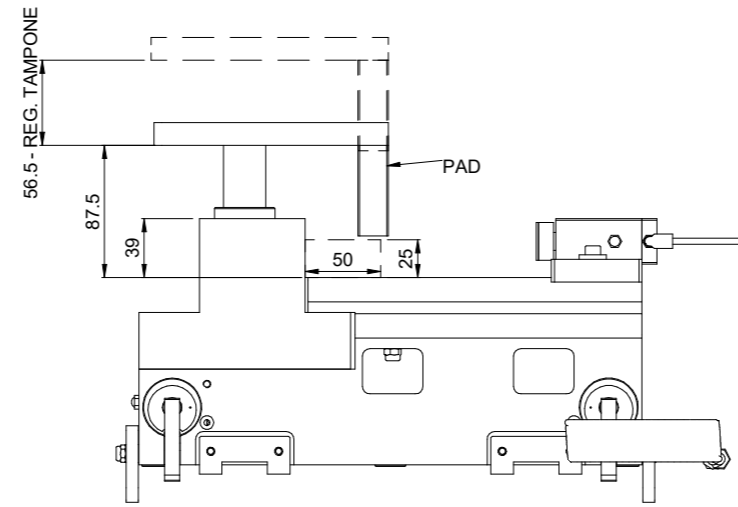
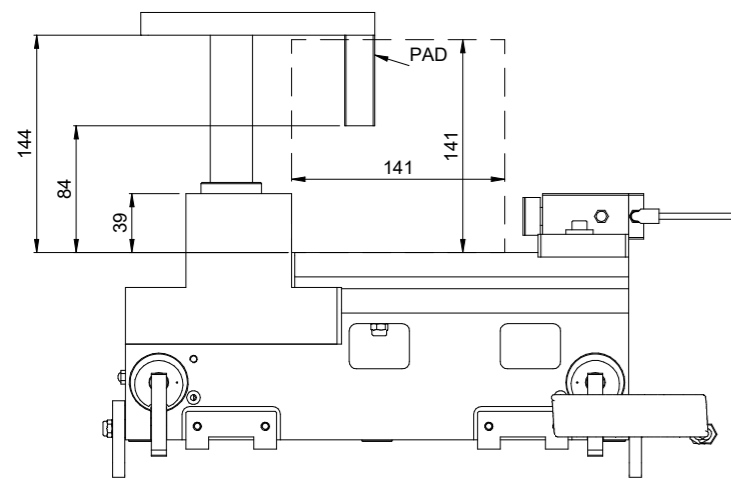
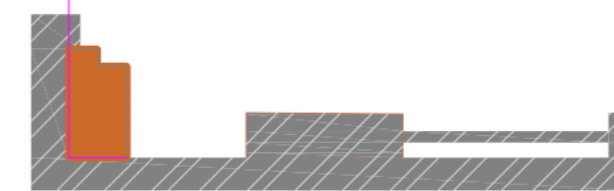
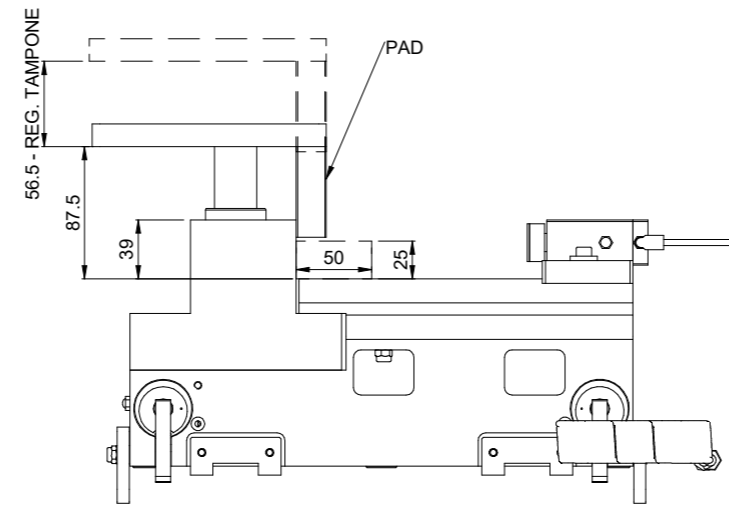
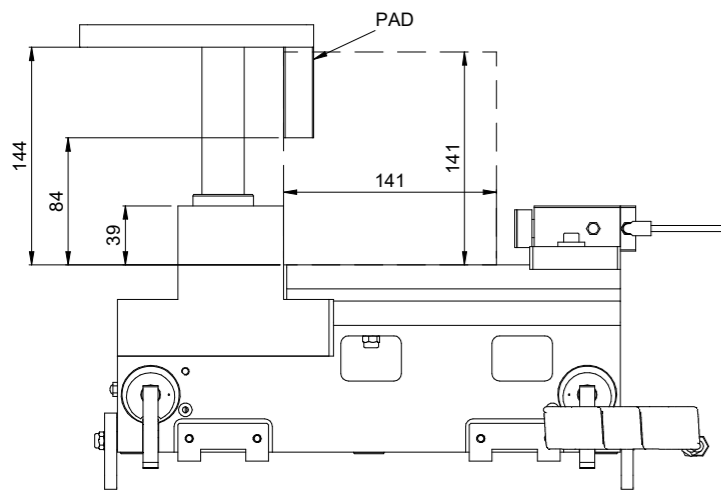

-When clamping at a width of 20mm, the minimum height workpiece is 42mm.

NO VERTICAL CLAMPING

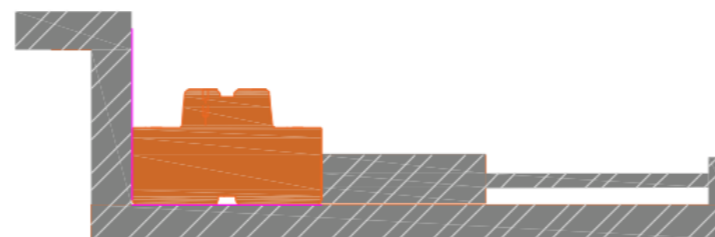
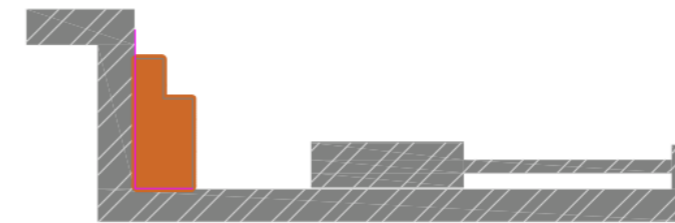
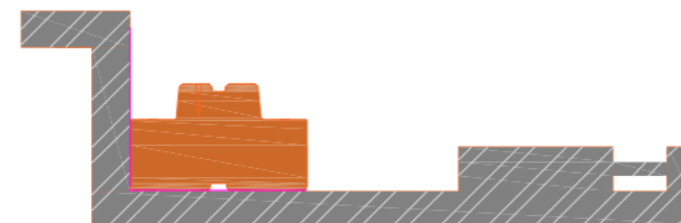
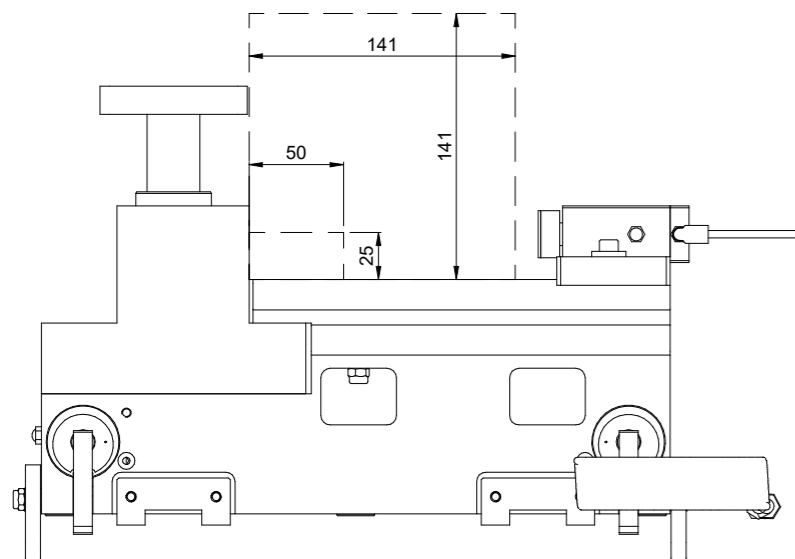

-No problem when vertical clamping is disable

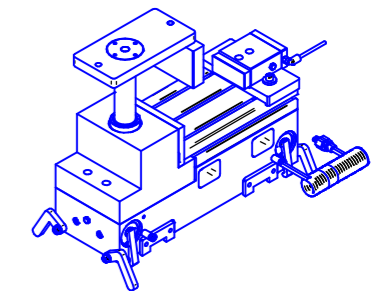

TOLLERANZE GENERALI : UNIFICAZIONE INTERNA

		2		SOSTIT. GRUPPI PER UNIFIC. E MOD. CAMPO 45-102		ND
FORMATO: A1	1	MODIFICATO OGPO099F.AUMENTATO CORSA		MODIFICA		GS
SCALA: 1:2.5	REV.					FIRMA
RICAVARE DA:	PESO: 7.577	DISEGNATO: GABRIELLI S.		LAVORAZIONI MECCANICHE		
MATERIALE:	CONTROLLATO:			SALDOCARRENTERA		
TRATTAMENTO SUPERFICIALE:	DATA: 29/02/2016			DETTI		
TRATTAMENTO TERMICO:						
DENOMINAZIONE: PRESSORE 1 MOV. H=125 CON BLOCC. PNEUM. CAMPO H=45-102 DPR0215X						
Ci riserviamo a termini di Legge la proprietà di questo disegno con divieto di riprodurlo o di renderlo comunque noto a terzi senza la nostra approvazione						
DATA DI STAMPA:	STATO:	DESTINATARIO:				